



# Audio Conferencing to support a 'Return to Work'

## The hybrid workforce

With current UK government guidelines encouraging the safe return to work with recommendations on how to do this, many organisations will move towards having a hybrid workforce with both remote and in-office workers. This means that during meetings it is highly likely that you will have remote participants joining. Having inaudible participants on a conference call is frustrating and wastes time. The confusion of neither being able to hear nor make your contribution effectively is one of the greatest meeting disruptors.

Nureva's HDL audio conferencing solutions have the power to simultaneously process every audio source in a room and deliver a more natural sense of communication. Capable of handling 15,000 million instructions per second, they are much more powerful than conventional systems. Installation is easy. Calibration is automatic and continuous to provide optimal performance with minimal hassle. The result is the best quality sound for people in and out of the room, no matter where each is standing, how they move or what direction they are facing.

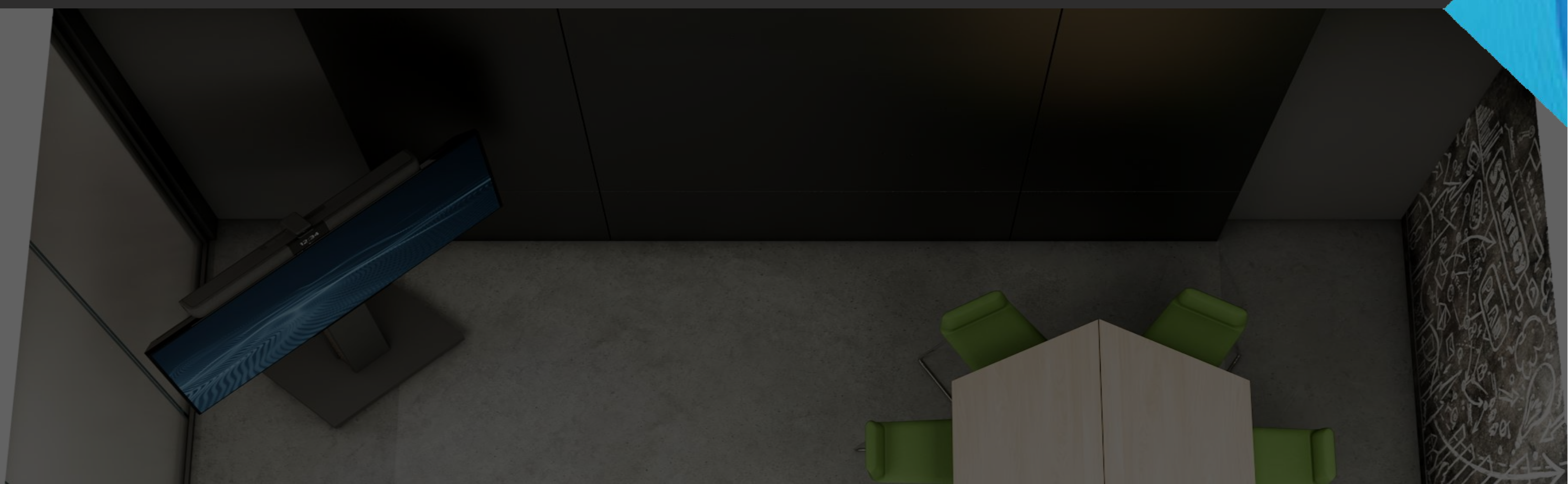



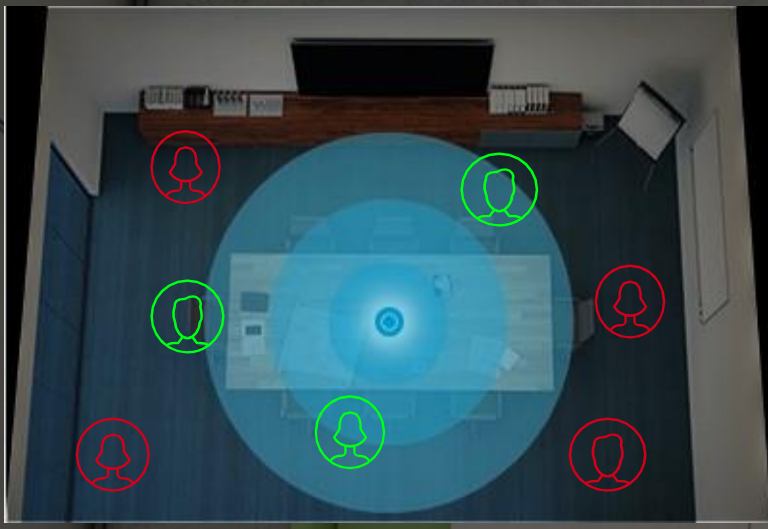

**Desktop  
omnidirectional**

Budget system with pickup limited to those seated at the conference table.

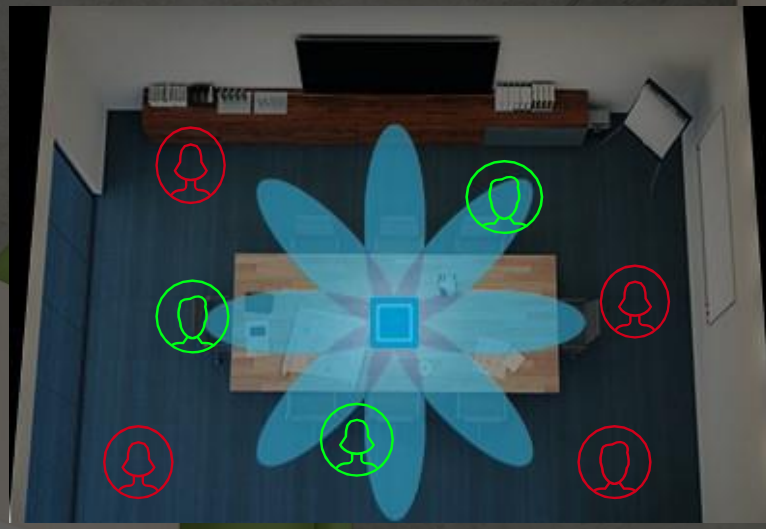

**Beamforming**

Higher cost in-ceiling system with coverage limited to the areas within the audio beams.

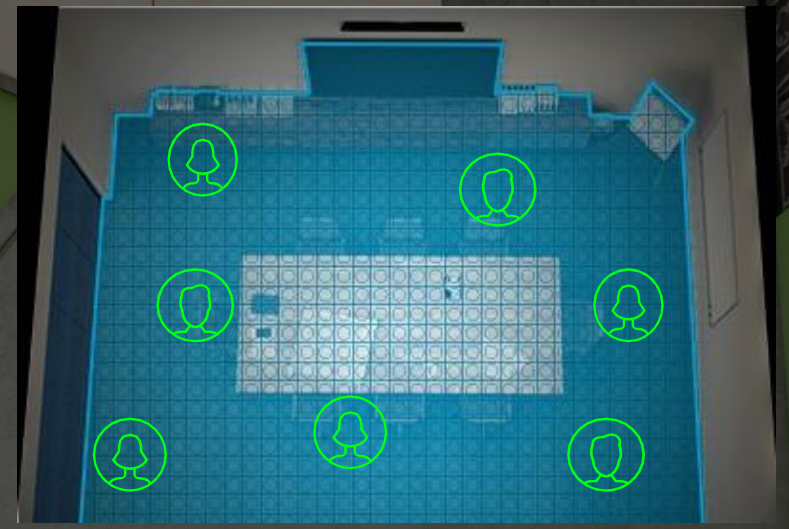

**Microphone Mist  
technology**

Moderately priced virtual microphone system provides true full-room pickup.

## Social distancing with Microphone Mist

Traditional microphone pick-up is based on proximity – the closer you are to the microphone the better the pick-up, but this method of audio conferencing doesn't support recent government guidelines recommending social distancing.

Traditional systems are also 'dumb' so the microphone will pick-up any sounds in the room. This can cause issues with echo and reverberation and means that undesirable noises are also picked up. Common examples of this include air conditioning systems and noises from other technology in the room, these persistent noises are automatically eliminated by microphone mist.

Traditional systems offer little flexibility such as zoning and often pick up noise based on proximity and nothing else.

Nureva's Microphone Mist fills a space with virtual microphones in the form of a grid and intelligently auto-calibrates to learn the size of the room. Once set up, participants audio can be picked up from anywhere in the room. The system is intelligent rather than dumb so it eliminates echo and prioritise the human voice over other noises. This creates natural, seamless audio - a microphone system that "just works" provides a great audio experience.

Nureva audio conferencing solutions deliver the best audio performance for all your meeting rooms. Your teams can socially distance and work safely in the same meeting room. All systems can be installed on the wall in minutes. And support plug-and-play connectivity to almost all leading UC&C platforms. With auto-calibration capability that means the entire solution is simple and scalable.





# Controlling Nureva Audio

If your organisation uses multiple HDL systems, Nureva’s cloud-based Console allows the management across multiple locations from a single, secure dashboard. Whether working on Windows or Mac, this scalable system lets one person configure and maintain all HDL units, regardless of if you have 1 or 10,000. It’s another tool that supports unnecessary movement around buildings, letting a central administrator check the status from anywhere they are basing themselves and means a minimal need for IT staff to visit meeting spaces.

## Key Features:

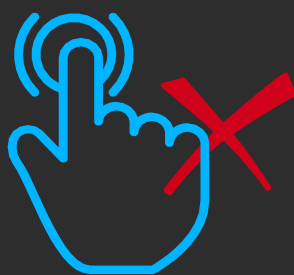

Touchless user experience to prevent cross contamination



Remote monitoring and device management with Nureva Console.

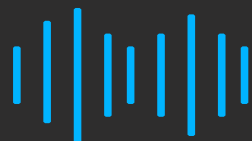

Configurable microphone pickup zone for open spaces

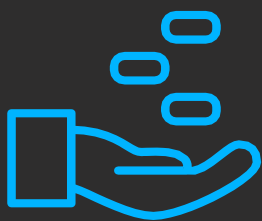

Mic large/ open spaces for a fraction of the cost of ceiling mounted systems



Distributed meetings are here to stay so help your teams stay connected

A scalable platform to cover any room upto 15.2 x 9.1m



Dual HDL300

For large spaces up to 30' x 50' | 15.2 x 9.1 m



HDL300

For mid-size spaces up to 25' x 25' | 7.6 x 7.6 m

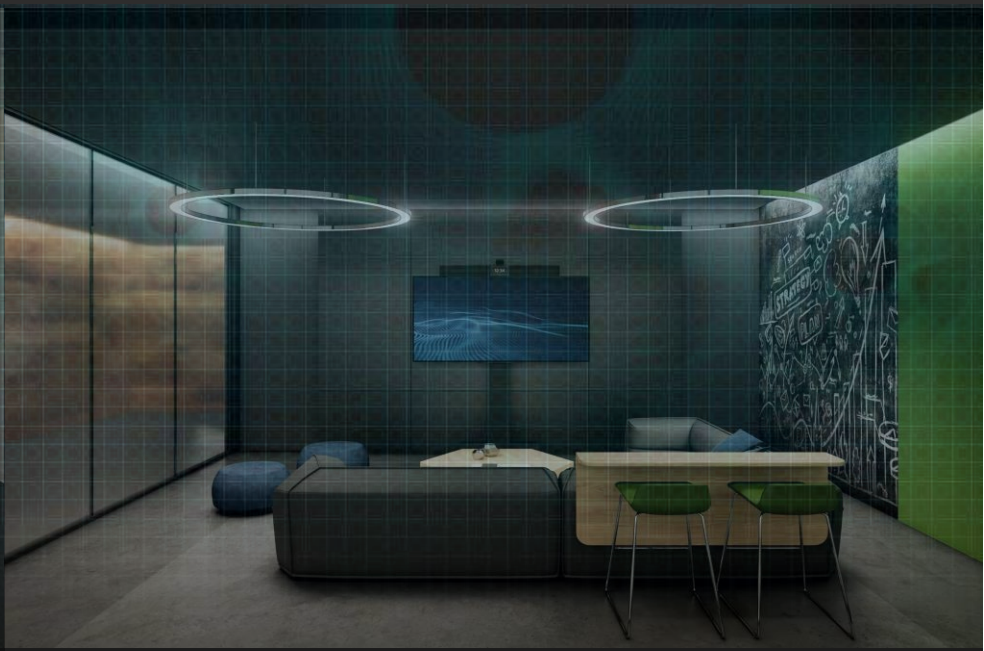

HDL200

For small spaces up to 18' x 18' | 5.5 x 5.5 m



## So, why choose Nureva audio conferencing solutions?

The chances are that a significant percentage of workforces will be homeworking for a while. And those that are physically present will be seated further away from one another to maintain social distancing.

Nureva audio provides a unique solution that can support a safe return to work, with scalable audio solutions that can provide full audio pickup for any sized room that can be controlled remotely.

### Nureva audio offers:

- Scalable, easily deployed audio conferencing platforms
- Natural microphone pick-up in rooms of all sizes
- Auto-calibration to maintain optimal performance and reduce installation time
- Wall-mounted to allow clear or flexible furniture configuration
- Total installation time of 30 mins or less
- Active Zone Control enables defined audio zone pick-up
- Connectivity for a PC or video conferencing codec
- Compatibility with a wide range of video and audio-conferencing platforms

For more information or to book a demonstration, contact Newlandmedia on 01670 714416 or [enquiries@newlandmedia.co.uk](mailto:enquiries@newlandmedia.co.uk)